

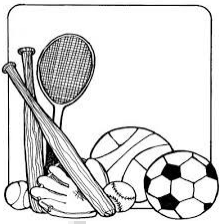

Stanislaus Dental Society Hits It Out
of the Park with the 4th Annual
Summer
Dental 
Symposium!



Friday, June 22, 2018

7:00am—Breakfast/Registration

8:00am-5:00pm-Symposium courses

Memorial Education Center

1700 McHenry Ave.

Modesto

Attendees who wear
an article of sports
gear get an extra raffle
ticket opportunity!

Sports Edition!

Exhibitor Registration

Stanislaus Dental Society will be holding its 4th Annual Summer Dental Symposium Friday, June 22 7:00am—5:00pm. Courses are designed to impact all levels of the dental profession and attendees will include dentists and staff from the Stanislaus area as well as those from surrounding dental components. Due to previous interest in attending events held by SDS, you are being invited to participate. There are several opportunities available. All levels of sponsorship will include sponsors name on all literature. Sponsorship levels are first-come, first-served.

Booths Include:

- 8'w x 6'd draped booth
- 5'w x 2'd skirted table
- 2 chairs
- ID sign
- Electrical outlets located throughout
(Notify the SDS office if you require an electrical connection.)

Pasteur/Curie, Barton, and Einstein are speaker rooms.
DaVinci is a break room.

Hotel accommodations can be made at:
 DoubleTree Hotel Best Western Lodge
 1150 9th St. Modesto 909 16th St. Modesto
 (209) 526-6000 (209) 524-7261

SpringHill Suites
 1901 W. Orangeburg Ave. Modesto
 (209) 526-2157

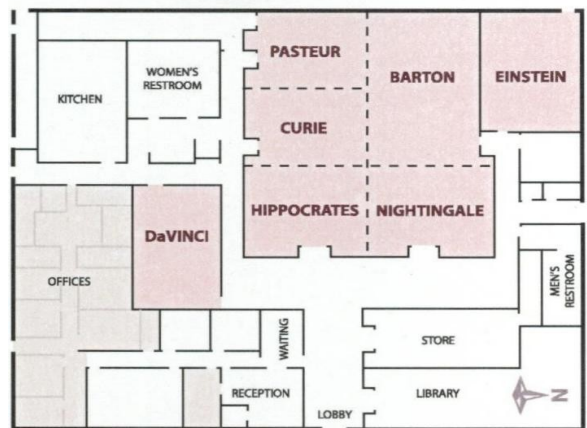
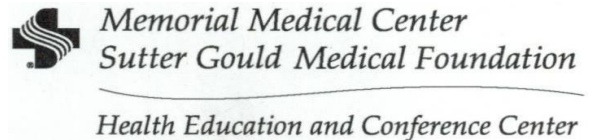

HIPPOCRATES

NIGHTINGALE

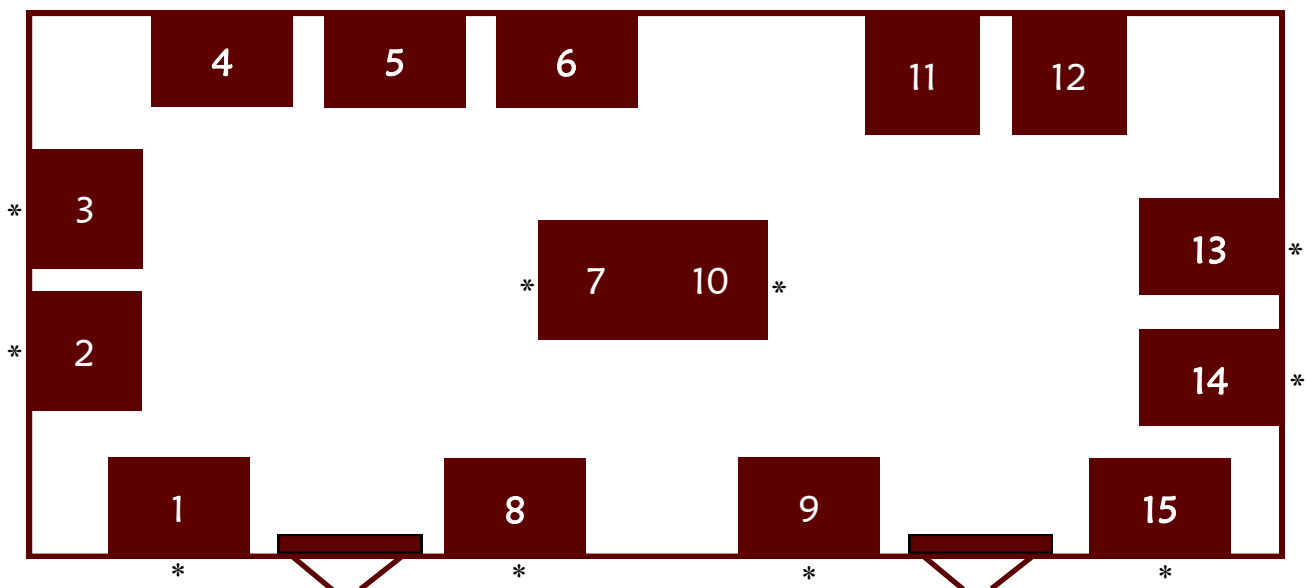

***Denotes booth that can have an electrical connection.**



Sponsorship Opportunities

Trade Booth (includes 2 reps and meals)-\$500
Additional rep: \$50
Speaker sponsorships available:
\$1,500 x 1 (Booth fee only—\$250)
\$2,000 x 1 (Booth fee waived)
Lanyards \$250 (sponsor to provide)
Company logo on tote bag—\$600

Summer Café

\$1,000 Breakfast
\$1,500 Sponsor-Name Breakfast Café
\$1,000 Lunch
\$1,500 Sponsor-Name Lunch Café
\$2,500 Sponsor-Name café, Both meals
\$500 Coffee Sponsor

Raffle Prize(s)

SDS leaves it up to each exhibitor whether you hold a raffle drawing at your booth; however, SDS would appreciate the donation of at least one raffle prize to be included in the main raffle drawing held at 5:00pm.

Special Lunch Drawing: During the lunch period, four exhibitors will be given \$50 to put in their pocket. During lunch, when the bell rings, whoever you are talking to receives the \$50!

Company Name:				
Address:				
City/State/Zip:				
Phone:		Email:		
#1 Name Sponsor Rep Attending:				
#2 Name Sponsor Rep Attending:				
Trade Booth Only (incl. 2 reps) ____		Lanyards ____	Coffee ____	Tote Logo ____
Breakfast ____	Bk Sponsor-Name Café ____	Lunch ____	Lunch Sponsor-Name Café ____	Both Meals Sponsor-Name ____
Speaker Sponsorship: \$500 ____	\$1,500 ____	\$2,000 ____	Raffle Prize(s) 1 ____ or 2 ____	
Preferred booth choice (1-15): 1st ____ 2nd ____ 3rd ____ Electrical Connection Needed? Yes <input type="checkbox"/> No <input type="checkbox"/>				

Payment and Cancellations (must be received in writing)

- Booth assignments confirmed by June 8 and notification sent to email address listed above.
- Cancellations made by June 8=50% refund. No refunds issued after June 8.

Payment by c/c or check (payable to Stanislaus Dental Society) and must be received by June 1

of Representatives attending: _____

C/C # _____

Expiration: ____/____ CVV#: _____ Amount: _____

Return a copy of this form with payment and mail to:

Stanislaus Dental Society/2401 E. Orangeburg Ave. Ste 675-319/Modesto, CA 95355/Ph: (209) 522-1530

If paying by c/c, form may be faxed (209) 522-9448 or emailed, sdsdent@thevision.net



If this is your first time as an SDS sponsor or your company has changed their logo since the last time you were an SDS sponsor, please provide a .jpg or pdf of your company logo for inclusion on all literature as well as your trade booth.